

## Polycrystalline Solar Module

CE-20/22P36

### Warranty

10-year repair and workmanship warranty

12-year warranty at 90% power output

25-year warranty at 80% power output

### Typical Electrical Characteristics

Models	CE-20P36	CE-22P36
Max. Power (Pmax)	20Wp	22Wp
Optimum Operating Voltage (Vm)	18.1V	18.2V
Optimum Operating Current (Im)	1.10A	1.21A
Open-circuit Voltage (Voc)	22.1V	22.3V
Short-circuit Current (Isc)	1.19A	1.31A
Module efficiency	11.5%	12.7%

Note: the specifications are obtained under the Standard Test Condition (STC): 1,000W/m<sup>2</sup>, Am 1.5, Cell Temperature 25°C

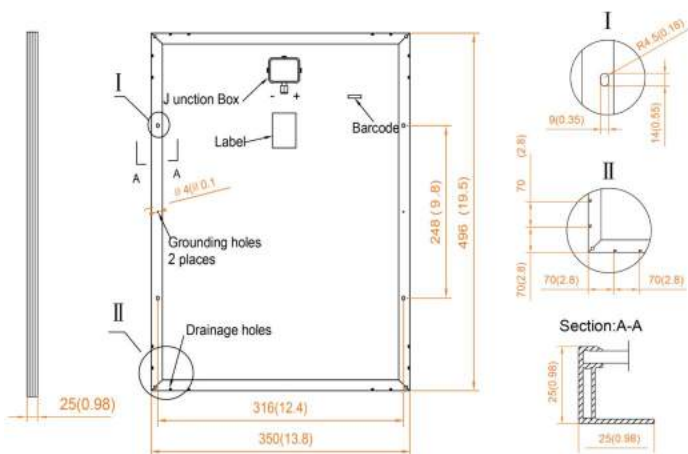

Solar cell	Poly-crystalline 156.75×22.3mm
Power Tolerance (Pmax)	0 ~ +3%
Numbers of cells	36pcs of cells in series
Module Dimension	496×350×25mm
Weight	2Kg
Max. System Voltage	1000V DC
Max. Series Fuse Rating	16A
Temperature cycling range	-40°C ~ +85°C
NOTC	45±2°C
Temperature coefficients of Isc	(+0.04%/°C)
Temperature coefficients of Voc	(-0.31%/°C)
Temperature coefficients of Pmax	(-0.4%/°C)